



Public Webinar Series

Title: **LSVT Companion® System, Home Edition
Demonstration**

Presenters: Angela Halpern, MS, CCC-SLP
Beth Peterson, MA, CCC-SLP

Date Presented: November 13, 2014

Disclaimer:

The information provided in this webinar and handout is not a substitute for medical or professional care, and you should not use this information in place of a visit, call consultation or the advice of your physician, speech, physical or occupational therapist, or other healthcare provider.

Copyright:

The content of this presentation is the property of LSVT Global and is for information purposes only. This content should not be reproduced without LSVT Global's permission.

Contact Us:

Web: www.lsvtglobal.com Email: info@lsvtglobal.com

Phone: 1-888-438-5788 (toll free), 1-520-867-8838 (direct)

LSVT Companion® Home Edition Demonstration for LSVT LOUD Certified Clinicians

Elizabeth Peterson, MA, CCC-SLP

Chief Speech Technology Officer
LSVT LOUD Expert Clinician
LSVT LOUD Training and Certification Faculty, LSVT Global, Inc.

Cynthia Fox, PhD, CCC-SLP

Research Associate, National Center for Voice and Speech
Co-Founder, LSVT Global, Inc.
LSVT LOUD Training and Certification Faculty, LSVT Global, Inc.

This work was supported, in part, by the:
National Institutes of Health

Michael J. Fox Foundation Copyright© LSVT Global, Inc.
2017

Information on CEUs

- This webinar is offered for 0.1 CEUs.
- Attendance for the full hour is required to earn CEUs.
- The LSVT Global webinars for 2014 are not registered for ASHA CEUs.
- You will receive a certificate after completion of the webinar which will include your name, date of the webinar and the number of hours earned.
- Completion of the webinar cannot be reported to the ASHA CE registry by us and cannot be added to the ASHA CE registry by you. Please retain documentation for proof of completion.
- For more information on including non-ASHA registered CEUs for certification maintenance, visit ASHA's website: <http://www.asha.org/Certification/Certification-Maintenance-Frequently-Asked-Questions-Earning-Professional-Development-Hours/#earnASHA>
- Licensing requirements for CEUs differ by state. Check with your state licensing board to determine if your state accepts non-ASHA registered CEUs.

Copyright© LSVT Global, Inc.
2017

Plan for Webinar

Logistics

Brief Overview of the LSVT Companion,
Home Edition

Demonstration of the LSVT Companion,
Home Edition

Address your questions

Copyright© LSVT Global, Inc.
2017

Greetings from....

Elizabeth Peterson, MA, CCC-SLP

Chief Speech Technology Officer
LSVT LOUD Expert Clinician
LSVT LOUD Training and Certification Faculty,
LSVT Global, Inc.

Cynthia Fox, PhD, CCC-SLP

Research Associate, National Center for Voice and Speech
Co-Founder, LSVT Global, Inc.
LSVT LOUD Training and Certification Faculty,
LSVT Global, Inc.

Copyright© LSVT Global, Inc.
2017

Learning Outcomes

Upon conclusion of this webinar, speech-language pathology participants will be able to:

- Outline the rationale for the development of technology used to increase accessibility of LSVT LOUD for clients and clinicians.
- Explain the research data supporting the use of technology-assisted treatment delivery.
- Describe the various ways the LSVT Companion, Home Edition can be used to assist in treatment, homework practice, and continued maintenance.

Copyright© LSVT Global, Inc.
2017

Instructor Biographies

Elizabeth Peterson, M.A., CCC-SLP

Ms. Peterson received her master's degree in Speech, Language and Hearing Sciences from the University of Colorado-Boulder. She began working with Dr. Lorraine Ramig's research team at the National Center for Voice and Speech in Denver, studying voice and speech disorders in Parkinson disease, while completing her master's thesis. Ms. Peterson is LSVT LOUD™ certified. In addition to providing LSVT LOUD to individuals with Parkinson disease and other neurological disorders she is the Chief Speech Technology Officer for LSVT Global Inc., working to enhance treatment accessibility through technology. Ms. Peterson is also an LSVT LOUD faculty member for LSVT Global, Inc., training and certifying speech-language clinicians in the delivery of LSVT LOUD.

Cynthia Fox, Ph.D., CCC-SLP

Dr. Fox received her doctorate degree in Speech and Hearing Sciences from the University of Arizona, Tucson. Dr. Fox is a Research Associate at the National Center for Voice and Speech, an affiliate of the University of Colorado-Boulder and Co-Founder of LSVT Global, Inc. Dr. Fox is among the world's experts in speech treatment for people with Parkinson disease. She has multiple publications in this area of focus, as well as numerous national and international research and clinical presentations. Dr. Fox has worked closely with Dr. Ramig for the past 15 years on studies examining the efficacy of LSVT LOUD™, the underlying mechanisms of speech disorders in Parkinson disease, and the application of LSVT LOUD to other disorders (children and adults) and other motor systems (e.g., limb). She is an expert on rehabilitation and neuroplasticity and the role of exercise in the improvement of function consequent to neural injury and disease.

Disclosures

Dr. Fox receives lecture honorarium and travel reimbursement and has ownership interest in LSVT Global, Inc. Ms. Peterson is an employee of and receives lecture honorarium and travel reimbursement from LSVT Global, Inc.



STATEMENT ON DISCLOSURE AND CONFLICT: All members of this research team have fully disclosed any conflict of interest (Ramig and Fox) and their conflict of interest management plan has been approved by the Office of Conflict of Interest and Commitment at the University of Colorado, Boulder.



Barriers to Maintenance Also Exist:



- Patients have good immediate post-treatment outcomes, but have difficulty maintaining because:
 - They need feedback on the quality of their practice
 - Incentives to practice
 - Accountability for quality and quantity of practice

Our responsibility is to help patients establish a **“life-long”** habit of practice!

**Great advances have been made in successful speech treatment for people with Parkinson disease!
Over 11,000 LSVT LOUD Certified Clinicians in 54 countries**



But we have more work to do!!!!

Need for solutions

- Growing interest in “in home” delivery of speech treatment protocols via telepractice and technology
- Speech/language intervention is often well tailored for distance and technology

Copyright© LSVT Global, Inc.
2017



Some Barriers to Access Still Exist:



- Lack of awareness about speech disorders in PD and LSVT LOUD
- Geographic barriers
- Financial constrains
- Not enough LSVT LOUD certified clinicians

Copyright© LSVT Global, Inc.
2017

Need for solutions

- LSVT LOUD is ideal for these applications
 - Standardized 16 session protocol
 - Well-defined outcome measures
 - Sound Pressure Level (SPL)
 - Fundamental frequency (F0)
 - Duration

Copyright© LSVT Global, Inc.
2017

Our solution

Technology supported delivery of LSVT LOUD through the LSVT Companion®

- Independent “at-home” clinician for a portion of LSVT LOUD sessions, homework practice, and maintenance

Copyright© LSVT Global, Inc.
2017

LSVT Companion

- Current system includes
 - Downloadable and interactive software
 - Proprietary SPL calibrated microphone
- Minimum system requirements
 - Microsoft® Compatible 1GHz Pentium Class Computer with 512 Mb RAM, running Windows® 2000 SP4, XP SP2, VISTA, Windows 7 or Windows 8 operating systems and Microsoft Excel

Copyright© LSVT Global, Inc.
2017



LSVT Companion®

Funded by: NIH-NIDCD &
Michael J. Fox Foundation

Key Features

- Provides audio and visual feedback based on goals set by the clinician
- Text and conversation practice can be personalized by clinician
- Automatically obtains calibrated SPL, F0 and duration for treatment and/or homework practice
- Clients can easily e-mail results files (Excel format) for clinician review

Copyright© LSVT Global, Inc.
2017

LSVT Companion

- Originally developed by
 - Matos, Ramig, Halpern, Bennett at University of Colorado – Boulder
 - Research funded by National Institutes of Health and Michael J Fox Foundation (Research study)
- Additional development for commercialization (translational)
 - LSVT Global, Inc. (Halpern, Ramig, McFarland and Fox)
 - Magpie Telecom Insiders
 - Lucinda Sanders

Copyright© LSVT Global, Inc.
2017



Clinician Edition

- Pre/post assessment
- Within treatment data collection
- Client exercises
- Text Editor

Home Edition

- Client exercises only

Treatment Delivery

- Week 1:
 - 4 F2F, training on the LSVT Companion Day 4
- Week 2:
 - 1 F2F, 1 LSVT Companion, 1 F2F, 1 LSVT Companion
- Week 3:
 - 1 F2F, 3 LSVT Companion
- Week 4:
 - 1 F2F, 2 LSVT Companion, 1 F2F

Copyright© LSVT Global, Inc.
2017

Potential Uses for the LSVT Companion, Home Edition

1. Homework practice during LSVT LOUD treatment
 - Clinician can program goals for 6 reps of exercises
 - Clinics can purchase Home Edition license(s) to loan to clients during the month of treatment
2. Independent treatment sessions at home (Halpern, et al. 2012)
3. Maintenance home practice at the end of LSVT LOUD treatment

Pre, Post, 6 month dB SPL (p< 0.001)

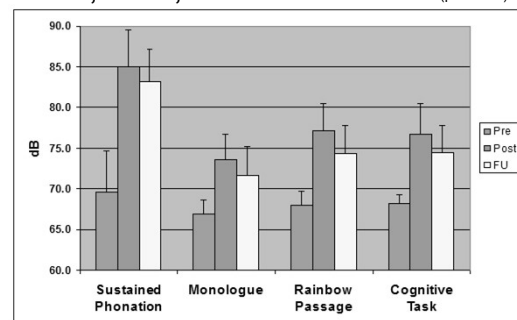

Changes consistent with those reported in previously published data
Copyright© LSVT Global, Inc.
Halpern et al, 2012

NIH R21

- 16 individuals with PD
- 7 of 16 LSVT sessions at home with LSVT Companion
- Alternated sessions in a specific way to monitor progress, shape the voice, drive home calibration and update goals

Copyright© LSVT Global, Inc.
2017

Maintenance Patient Example

*"If you can't communicate, you are very isolated."
-Dr. Ralph Calatchi*

- Great post-treatment outcome
- Lack of incentive to practice at home
- Now, he uses the LSVT Companion to stay motivated to practice
- He likes the feedback feature and the freedom to practice during his frequent travel
- "It's made a huge difference."

<https://www.michaeljfox.org/foundation/news-detail.php?if-you-can-communicate-you-are-very-isolated>
Copyright© LSVT Global, Inc.
2017

LSVT Companion

- This product has been cleared by the FDA for marketing and sales
- CE clearance
- Australia clearance
- German translation (launched March, 2013)
- Pediatric FDA application in process

Copyright© LSVT Global, Inc.
2017

Calibrated Microphone

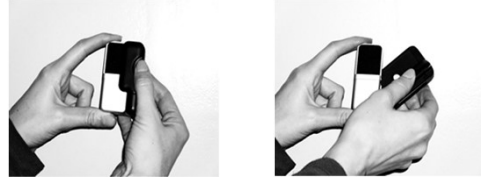

Copyright© LSVT Global, Inc.
2017

Preparing your clients for independent use:

1. Practice the functions with clients in your office prior to independent practice at home
2. Show clients how to embed updated goals you send
3. Show clients how to e-mail results files

Microphone Placement

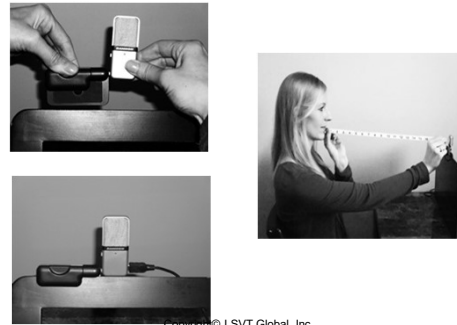

Copyright© LSVT Global, Inc.
2017

LSVT Companion, Home Edition

Let's take a look!!!!

Practical Implementation: Options

- Clinic purchases license(s) and loans out laptop(s) during month of treatment or set time after treatment
- Clinician sets up practice station in-clinic with Clinician Edition for post-treatment practice
- If clinic does not have LSVT Companion Clinician Edition, but client would like Home Edition, LSVT Global can work with clinician/client to provide targets file and text

Copyright© LSVT Global, Inc.
2017

Practical Implementation: Equipment

- PC based product. If client is a MAC user, recommend a netbook or cheap laptop
- Some clients have successfully implemented use of the LSVT Companion Home Edition on MAC computers using platform technology – LSVT Global has NOT tested validity of data

Copyright© LSVT Global, Inc.
2017

Practical Implementation: Private Pay

1. Patients will pay out of pocket. Don't assume they will not, or can not. Give them all the information and they can make an informed decision!
2. Parkinson Organizations have financed the purchase of LSVT Companion Home and Clinician Editions for LSVT LOUD clinicians who work in their community
3. Be creative and persistent! Communication is of great value and we have a lot to offer our patients with PD!!!

Copyright© LSVT Global, Inc.
2017

Practical Implementation: Ordering

1. LSVT LOUD Certified Clinician will prescribe LSVT Companion
2. Client or clinician can order through LSVT Global - we verify the LSVT LOUD Certified Clinician prior to processing sales

Copyright© LSVT Global, Inc.
2017

Questions

E-mail us at: lsvtc@lsvtglobal.com

View demos: www.lsvtglobal.com
Click on "Products" header and select
LSVT Companion System

Practical Implementation: Reimbursement

1. Check into reimbursement
 - Send letter to insurance company
 - Patient contact insurance company
 - Refer to system as device instead of software: FDA-cleared medical device
2. Know the company's policy: insurance policies for speech therapy are available online. (Cigna's is extensive and specifically mentions the LSVT-C under "computer based programs" – use that knowledge!)
3. LSVT Companion Home Editions have been successfully prescribed through some VA systems (e.g., prosthetics division)

Copyright© LSVT Global, Inc.
2017